

JASNAOE

2017 Annual Autumn Meeting Program

Organized by the Japan Society of Naval Architects and Ocean Engineers (JASNAOE)

November 27-28, 2017

International Conference Center Hiroshima

Schedule

Date	Events	Time	Room	
Nov. 27 (Mon.)	General sessions / Organized sessions	9:00~17:00	B1F, B2F	Room 1~5
	Poster session (Display only) One-minute presentation	10:30~18:20 13:00~13:20	B1F B2F	Conference lobby Room 1
	Special Lecture	17:20~18:20	B2F	Room 1
	Exhibition	9:30~18:20	B1F	Conference lobby
	Banquet	18:50~20:30	3F	ANA CROWN PLAZA Hiroshima (Orchid)
Nov. 28 (Tue.)	General sessions / Organized sessions	9:00~17:00	B1F, B2F	Room 1~5
	Poster session (Display only) Core time	9:00~16:00 13:00~13:40	B1F	Conference lobby
	Exhibition Luncheon seminar	9:00~17:00 12:20~13:00	B1F B1F	Conference lobby Room 3~5

CPD BANK Point Registration

Registration URL <http://www.cpdbank.com/jasnaoe/>

Target Event Annual Autumn Meeting of JASNAOE 2017

Event ID 1217 (Speaker), 1218 (Audience)

Credit Speaker : 3points, Audience: 1point

Notes The registration can be seen in the WEB site (<https://www.jasnaoe.or.jp/aboutus/office.html>)

Program

Date: 9:00~18:00 on Nov. 27(Mon.)-28(Tue.), 2017

Venue: International Conference Center Hiroshima

〒730-0811 1-5, Nakashima-cho, Naka-ku, Hiroshima

Reception : Conference lobby (B1F)

Room 1 : Dahlia ①②, B2F (Nov. 27), Dahlia ②, B2F (Nov. 28)

Room 2 : Cosmos ①, B2F

Room 3 : Conference Working Room ①, B1F

Room 4 : Conference Working Room ②, B1F

Room 5 : Conference Working Room ③, B1F

Fee : Member of JASNAOE 2,000 JPY (*Life member: Free)

Non-Member 5,000 JPY (*Author of organized session: 2,000 JPY)

Student Free (*CD-ROM proceedings is not distributed to Non-member student)

* The special web site can be freely accessed to see the accepted papers and the program schedule with the password announced by the reception desk.

* The free Wi-Fi service can be available as below:

Robby SSID : icch-free, PW : icc-h

Room SSID : icch-user, PW : icchu

Organized Sessions (OS)

OS1: The Forefront Activities of Earthquake and Tsunami Protection Measures

Organizer: Ei-ichi Kobayashi (Kobe University),

Mitsuhiro Masuda (Tokyo University of Marine Science and Technology),

Tomoya Inoue (JAMSTEC)

OS2: Experimental Study of Marine Renewable Energy Converters

Organizer: Motohiko Murai (Yokohama National University)

OS3: Review session of the Brazil-Japan Collaborative Program

on Naval Architecture and Offshore Engineering

Organizer: Toru SATO (University of Tokyo)

OS4: Integrated Engineering for Ocean Development

Organizer: Ken Takagi and Ryota Wada (University of Tokyo)

OS5: Japan-Korea International Collaboration ~Research on ship-motion related hydrodynamics~

Organizer: Masashi Kashiwagi (Osaka University)

Special Lecture

Date: 17:20~18:20, November 27, 2017

Room: International Conference Center Hiroshima, Room 1 (B2F)

Title: KANSEI Innovation for Nurturing Mental Wealth and Mono-zukuri

(making things — manufacturing) ~For realizing a “mentally enriched society”



Speaker: Mazda Motor Corporation, Technical Fellow of Technical Research Center, Takahide Nouzawa

Poster Session

Date: November 27(Mon.)~28(Tue.), 2017

Room: Conference lobby (B1F) and Room 1(B2F)

Display : Nov. 27 (Mon.) 10:30~18:20 Conference lobby (B1F)

Nov. 28 (Tue.) 9:00~16:00 Conference lobby (B1F)

One-minute presentation : Nov. 27 (Mon) 13:00~13:20 Room 1 (B2F)

Core time : Nov. 28(Tue) 13:00~13:40 Conference lobby (B1F)

Award: The excellent poster will be certificated from JASNAOE in Banquet.

Exhibition

Date: 9:30~18:20 on Nov. 27 (Mon.), 9:00~17:00 on Nov. 28 (Tue.)

Room: Conference lobby (B1F)

Exhibiting Companies: Creact International Corporation, ArchiveTips Inc.,
MSC Software Ltd., CMIWS Co., Ltd., Software Cradle Co., Ltd.,
Siemens PLM Software Computational Dynamics K.K.

Luncheon Seminar

Date: 12:20~13:00 (40 minutes) on Nov. 28, 2017

Room: Room 3 (B1F)

Organizing Company: CMIWS Co., Ltd.

Title: Introduction of the fiber optics sensing techniques

The number of Lunch Box: 25

Room: Room 4 (B1F)

Organizing Company: Software Cradle Co., Ltd.

Title: Invitation to the world of simulation for cavitation around a marine vessel

The number of Lunch Box: 35

Room: Room 5 (B1F)

Organizing Company: Siemens PLM Software Computational Dynamics K.K.

Title: Simulation Solution for Marine Industry using Simcenter Portfolio

The number of Lunch Box: 30

Banquet

Date: 18:50~20:30 on Nov.27(Mon.), 2017

Room: ANA CROWN PLAZA Hiroshima 3F Orchid

(*5 minutes walk from International Conference Center Hiroshima)

〒730-0037 7-20, Nakamachi, Naka-ku, Hiroshima-shi,

TEL (+81) 82-241-1111 FAX (+81) 82-241-9123

Fee: Registration (by Nov.17) 5,000 JPY (*Student and life member: 2,000 JPY)

Non-registration 7,000 JPY (*Student and life member: 3,000 JPY)

The attendance fee can be paid at the reception desk.

Location

- Conference: International Conference Center Hiroshima
(〒730-0811 1-5, Nakashima-cho, Naka-ku, Hiroshima)
<http://www.pcf.city.hiroshima.jp/icch/access.html>
- Banquet: ANA CROWN PLAZA Hiroshima 3F Orchid
(〒730-0037 7-20, Nakamachi, Naka-ku, Hiroshima-shi)
<http://www.anacrowneplaza-hiroshima.jp/access/index.html>



Floor Map (Conference)

B1F

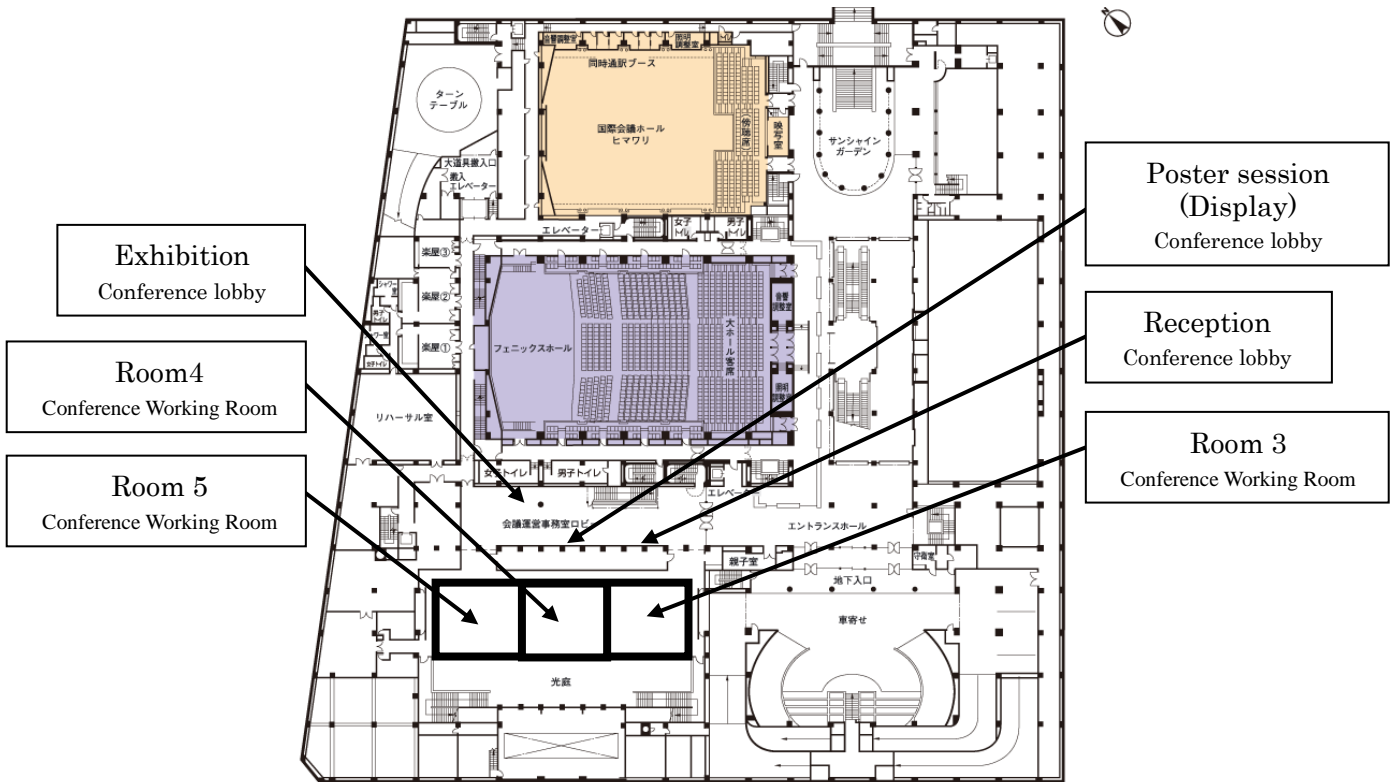

B2F

